

FOR SALE

Development Site

S 19th St & S Lawrence St | Tacoma WA

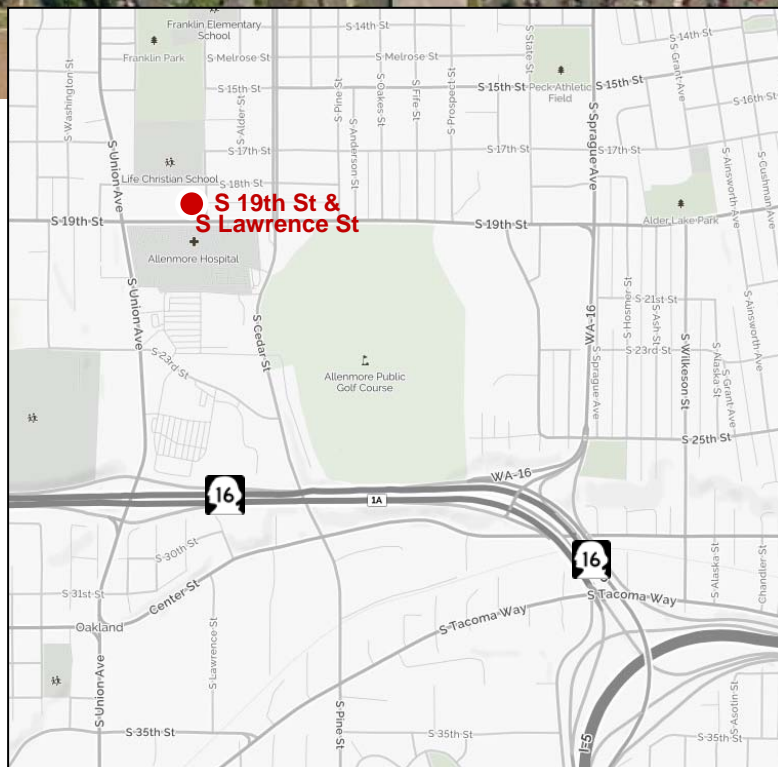

SALE PRICE \$1,690,000

Near Allenmore Medical Community

- 43,000 SF Site (6 parcels)
- Great site for Medical, Office, Retail, Senior housing or Multifamily development
- Prominent location in the Central District of Tacoma
- Directly across from Allenmore Medical Center
- Zoned CCX-Community Commercial Mixed Use
- Presently has 6 rental houses on month-to-month leases

Tom Brown
NEIL WALTER COMPANY
253.779.2427
brown@neilwalter.com

Shelly Hu
RE/MAX PACIFIC REALTY
425.443.5668
hu.shelly@gmail.com

Development Site

S 19th St & S Lawrence St | Tacoma WA

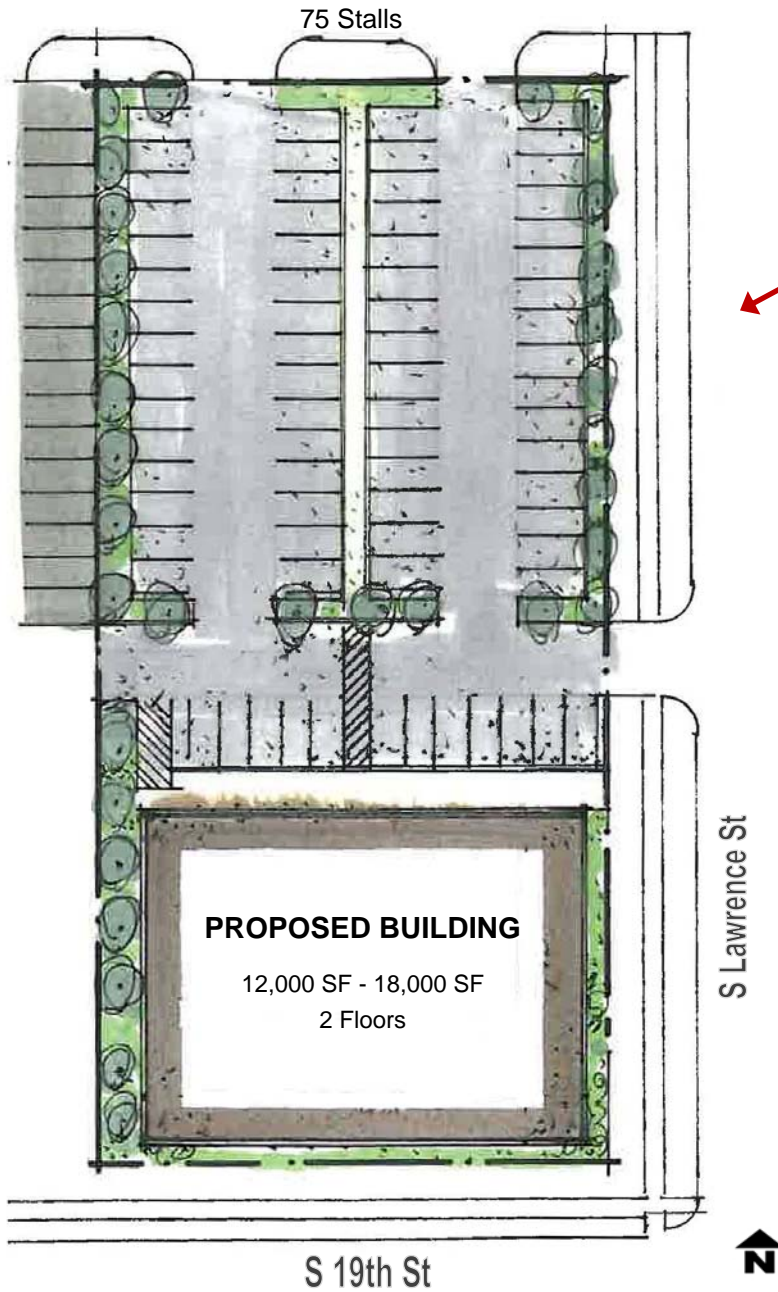

Tom Brown
NEIL WALTER COMPANY
253.779.2427
tbrown@neilwalter.com

Shelly Hu
RE/MAX PACIFIC REALTY
425.443.5668
hu.shelly@gmail.com



Neil Walter Co: 1940 E D St, Suite 100 - Tacoma, WA 98421

Re/Max Pacific Realty: 15015 Main St, Suite 205 - Bellevue, WA 98007

All square footage references are approximate. The information contained herein is from sources deemed reliable. It is provided without representation, warranty or guarantee, expressed or implied as to its accuracy. Prospective Buyer or Tenant should conduct an independent investigation and verification of all matters.