

# 27,089 SF Total

## Industrial Space For Lease



## Prologis Park Fife 45

7218 45th St Ct E, Suite 100  
Fife, WA 98424



### FEATURES

- 27,089 SF Shell; 2,561 SF Office
- Located 10 minutes from Port of Tacoma
- 6 DH loading doors with EOD levelers
- 1 GL loading doors
- 24' Clear height
- 120' Truck court
- No City of Fife B&O Tax
- Zoned Industrial
- Heavy power
- Available 09/01/2021

# 27,089 SF Total

## Industrial Space For Lease

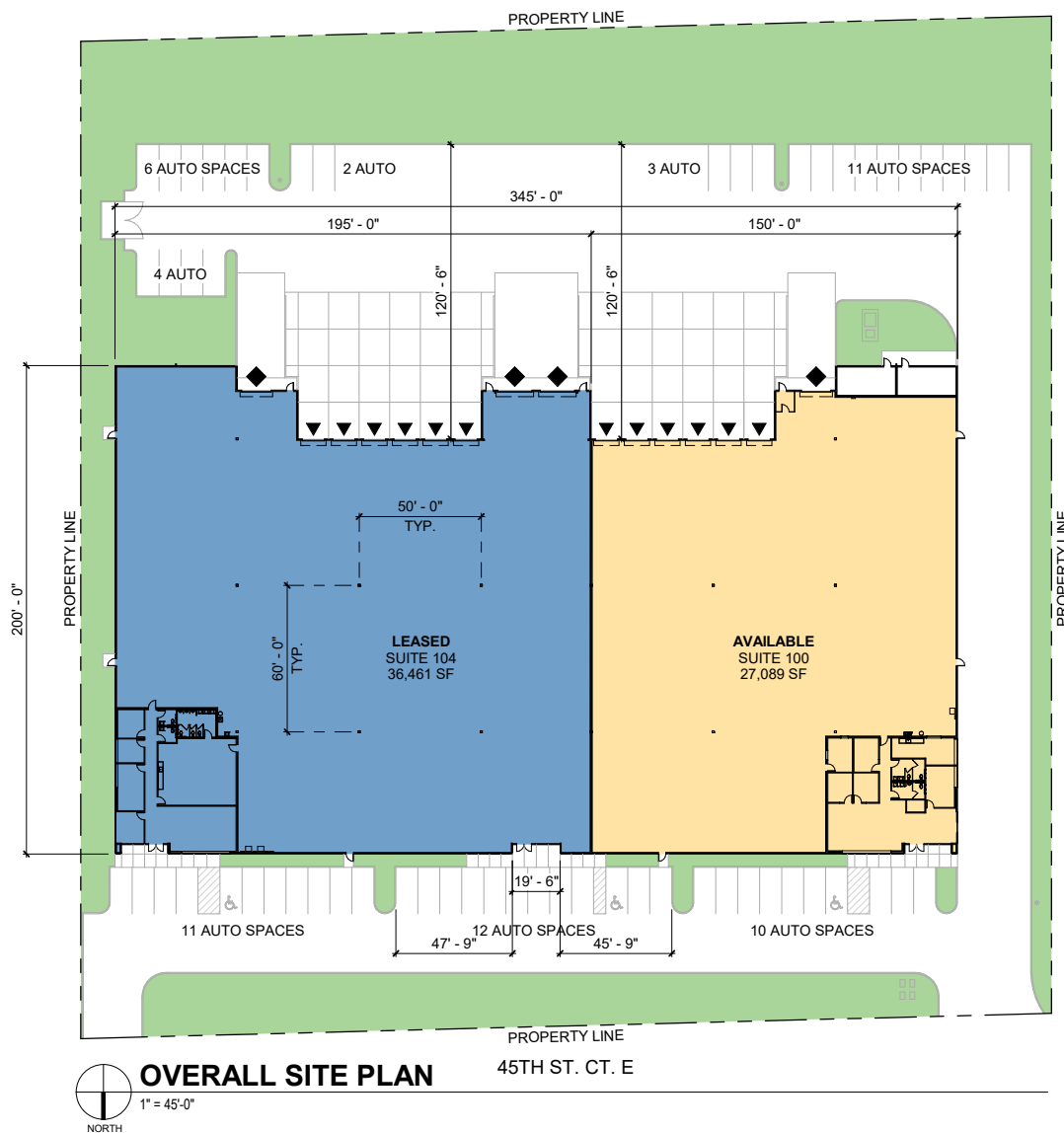

**Neil Walter Company**  
Kermit Jorgensen  
kjorgensen@neilwalter.com  
206 787 1475  
550 S Michigan St  
Seattle, WA 98108

**Neil Walter Company**  
Scott Price  
sprice@neilwalter.com  
253 779 2419  
1940 East D St, Suite 100  
Tacoma, WA 98401

**Neil Walter Company**  
Joel Jones  
jjones@neilwalter.com  
253 779 2422  
1940 East D St, Suite 100  
Tacoma, WA 98401

**Prologis**  
Mark Roddy  
MRoddy@prologis.com  
206 414 7617  
12720 Gateway Dr, Ste 110  
Tukwila, WA 98168

No warranty or representation, expressed or implied, is made as to the accuracy of the information contained herein, and same is submitted subject to error and omissions.