

274,000 SF Available

Industrial Space For Lease



Prologis Puyallup 1

1601 Industrial Park Way
Puyallup, WA 98371

LOCATION

- Excellent access to Port of Tacoma, I-5 and Hwy-167
- In-park truck flow is excellent

FACILITY

- ±141,500 SF & ±132,500 SF Total Available
- ±274,000 SF Combined



SUITE 103

- ±141,500 SF
- Office BTS (existing 500 SF shipping office)
- 32 DH doors; 2 GL doors
- 16 Hydraulic pit levelers
- Concrete truck apron
- 30' clear height
- 50' x 50' column spacing
- ESFR sprinkler system
- Ample employee car parks
- 277/480-volt electrical service
- T-5 lighting
- Call for lease rate
- Available now

SUITE 101

- ±132,500 SF
- 13,000 SF Office
- 26 DH doors; 1 GL doors
- Concrete truck apron
- 30' clear height
- 50' x 50' column spacing
- ESFR sprinkler system
- Ample employee car parks
- 277/480-volt electrical service
- T-5 lighting
- Call for lease rate
- Available March 1, 2023

274,000 SF Available

Industrial Space For Lease



OVERALL SITE PLAN 1" = 100'-0"

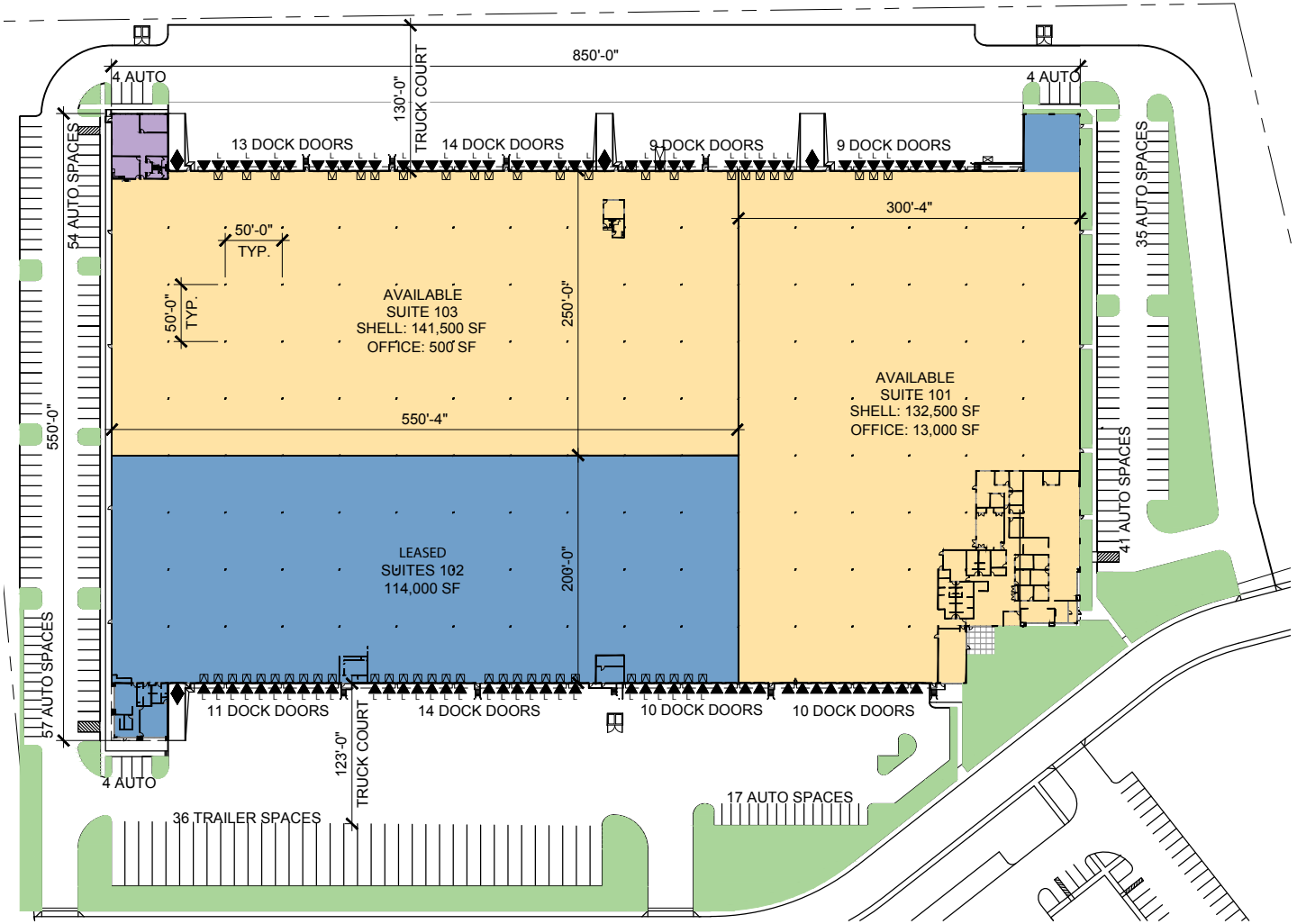

LEGEND:

- | | | | |
|-------------------------------|-------------------|------------------|-----------|
| ▲ DOCK DOOR | ◆ DRIVE-IN DOOR | ■ AVAILABLE AREA | ■ PLANNED |
| ▲ DOCK DOOR WITH DOCK LEVELER | ■ RAIL-LEVEL DOOR | ■ LEASED AREA | ■ LAND |

Neil Walter Company
Scott Price
 sprice@neilwalter.com
 253 779 2419
 1940 East D St, Suite 100
 Tacoma, WA 98421

Neil Walter Company
Bruce Valentine
 bvalentine@neilwalter.com
 253 779 2400
 1940 East D St, Suite 100
 Tacoma, WA 98421

KBC Advisors
Michael Roy
 michael.roy@kbcadvisors.com
 206 940 7199
 5628 Airport Way S #238
 Seattle, WA 98108

Prologis
Mark Roddy
 mroddy@prologis.com
 206 414-7617
 33930 Weyerhaeuser Way South, Suite 100
 Federal Way, WA 98001

No warranty or representation, expressed or implied, is made as to the accuracy of the information contained herein, and same is submitted subject to error and omissions.