

# CANYON ROAD INDUSTRIAL

5219 84TH AVE ST E | TACOMA, WA

FOR LEASE

3,000 SF  
AVAILABLE







## RARE LIGHT INDUSTRIAL SPACE AVAILABLE IN TACOMA



### LEASE INFO

Available:	3,000 SF
Office Size:	500 SF
Lease Rate:	\$3,300/Month
NNN Rate:	\$0.17/SF/Month

### PROPERTY FEATURES

-  2 grade-level doors
-  18' clear height
-  Secure paved yard/storage area
-  Central Pierce County location
-  Ideal for service and customer accessibility
-  Traffic counts over 15,553 vehicles per day



**DERRICK URQUHART**  
253.222.3360  
durquhart@neilwalter.com

All information references in this document are approximate. The information contained herein is contained from sources deemed reliable. It is provided without representation, warranty, or guarantee, expressed or implied as to accuracy. Prospective buyer or tenant should conduct its own independent investigation relating to the property, government codes and regulations, allowed uses, and all other matters, regardless of whether they are referred to or contained in this document.

# CANYON ROAD INDUSTRIAL



5219 84TH AVE ST E | TACOMA, WA

NEIL WALTER  
COMPANY

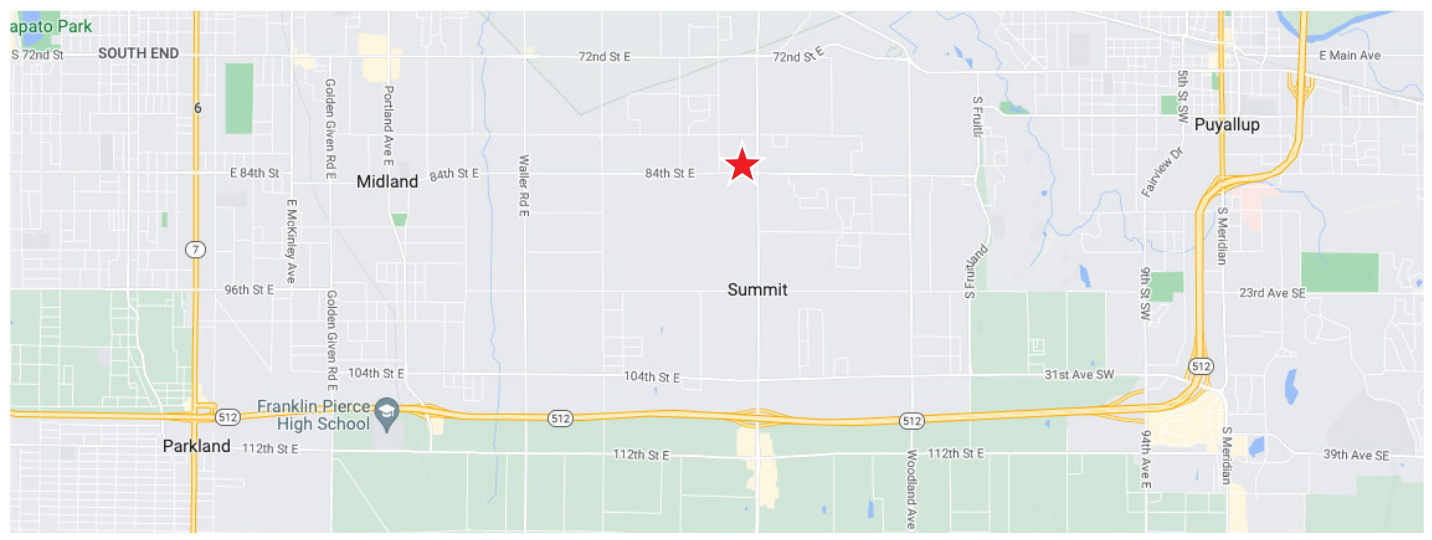

**DERRICK URQUHART**

253.222.3360

durquhart@neilwalter.com

253.779.8400  
www.neilwalter.com  
1940 East D St, #100  
Tacoma, WA 98421

All information references in this document are approximate. The information contained herein is contained from sources deemed reliable. It is provided without representation, warranty, or guarantee, expressed or implied as to accuracy. Prospective buyer or tenant should conduct its own independent investigation relating to the property, government codes and regulations, allowed uses, and all other matters, regardless of whether they are referred to or contained in this document.