

FIFE BUSINESS CENTER

4624-4630 16TH ST E | FIFE, WA

NEW OWNERSHIP



FOR LEASE - 3 SUITES AVAILABLE

FLEX WAREHOUSE/OFFICE SPACE



LEASE INFORMATION

BUILDING	SUITE	AVAILABLE SIZE	LOADING
B	9-10	4,543 SF	3 GL Doors
B	13-14	4,753 SF	3 GL Doors
A	4	1,674 SF	1 GL Door

PROPERTY HIGHLIGHTS

- New Cap-Ex Upgrades Completed
- Nearby amenities include food service, retail, banking, etc.
- Excellent I-5 and Port of Tacoma access
- Contact broker for lease rate

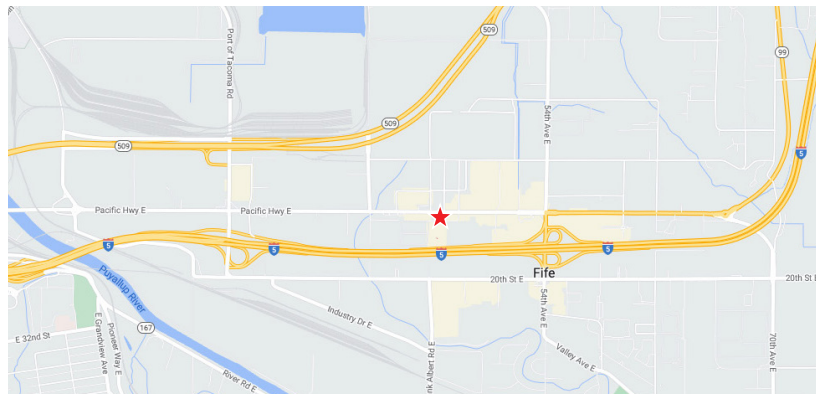

JOHN DEHAN
253.779.2433

jdehan@neilwalter.com

NICK RATZKE, SIOR
253.779.2414

nratzke@neilwalter.com

All information references in this document are approximate. The information contained herein is contained from sources deemed reliable. It is provided without representation, warranty, or guarantee, expressed or implied as to accuracy. Prospective buyer or tenant should conduct its own independent investigation relating to the property, government codes and regulations, allowed uses, and all other matters, regardless of whether they are referred to or contained in this document.

FIFE BUSINESS CENTER

4624-4630 16TH ST E | FIFE, WA

BUILDING B

SUITE	AVAILABLE SIZE	LOADING
B9-10	4,543 SF	3 GL Doors
B13-14	4,753 SF	3 GL Doors

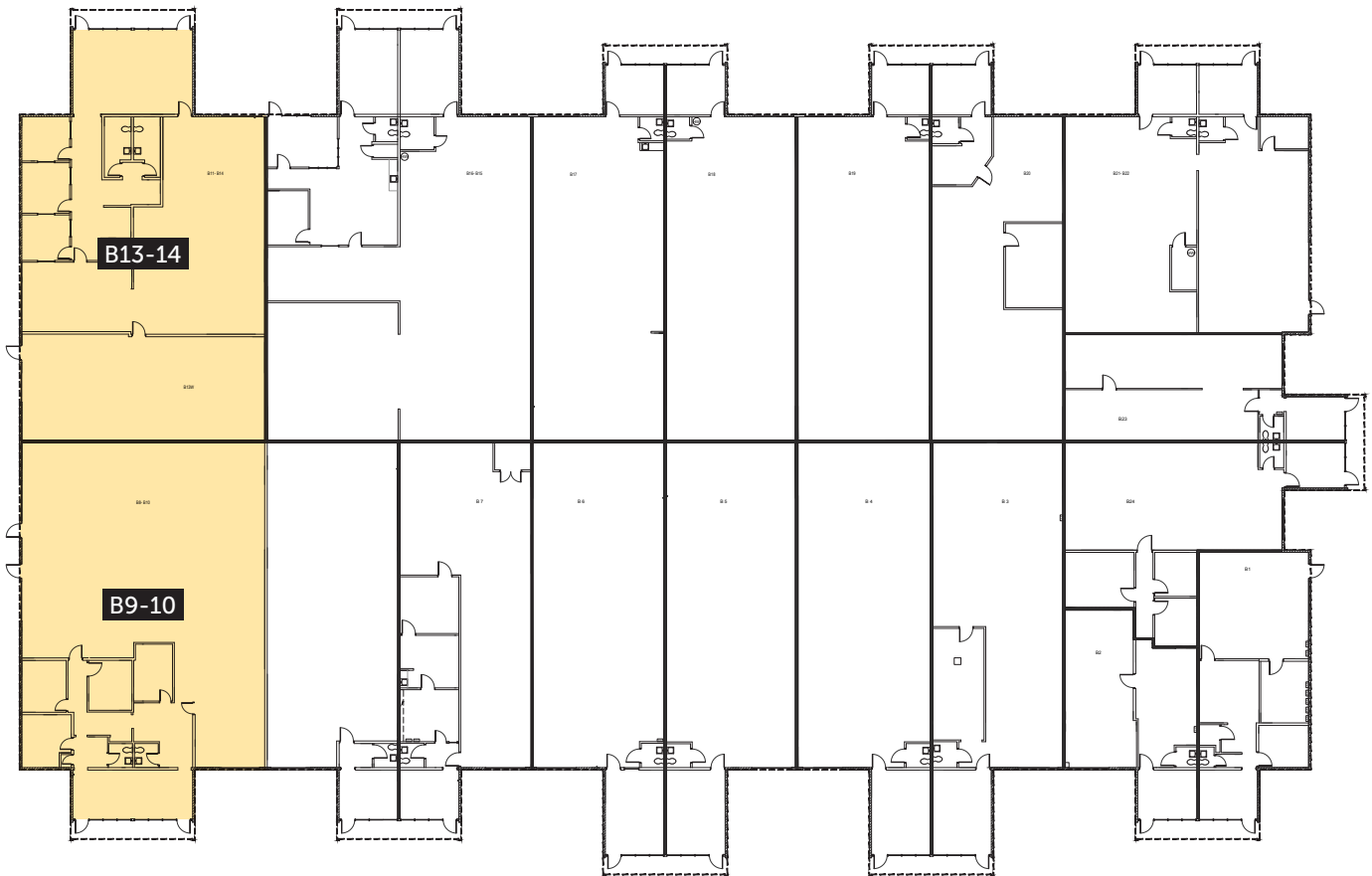

JOHN DEHAN
253.779.2433
jdehan@neilwalter.com

NICK RATZKE, SIOR
253.779.2414
nratzke@neilwalter.com

1940 East D St, #100
Tacoma, WA 98421
253.779.8400
www.neilwalter.com

All information references in this document are approximate. The information contained herein is contained from sources deemed reliable. It is provided without representation, warranty, or guarantee, expressed or implied as to accuracy. Prospective buyer or tenant should conduct its own independent investigation relating to the property, government codes and regulations, allowed uses, and all other matters, regardless of whether they are referred to or contained in this document.

FIFE BUSINESS CENTER

4624-4630 16TH ST E | FIFE, WA



NEIL WALTER
COMPANY

BUILDING A

SUITE	AVAILABLE SIZE	Loading
A4	1,674 SF	1 GL Door

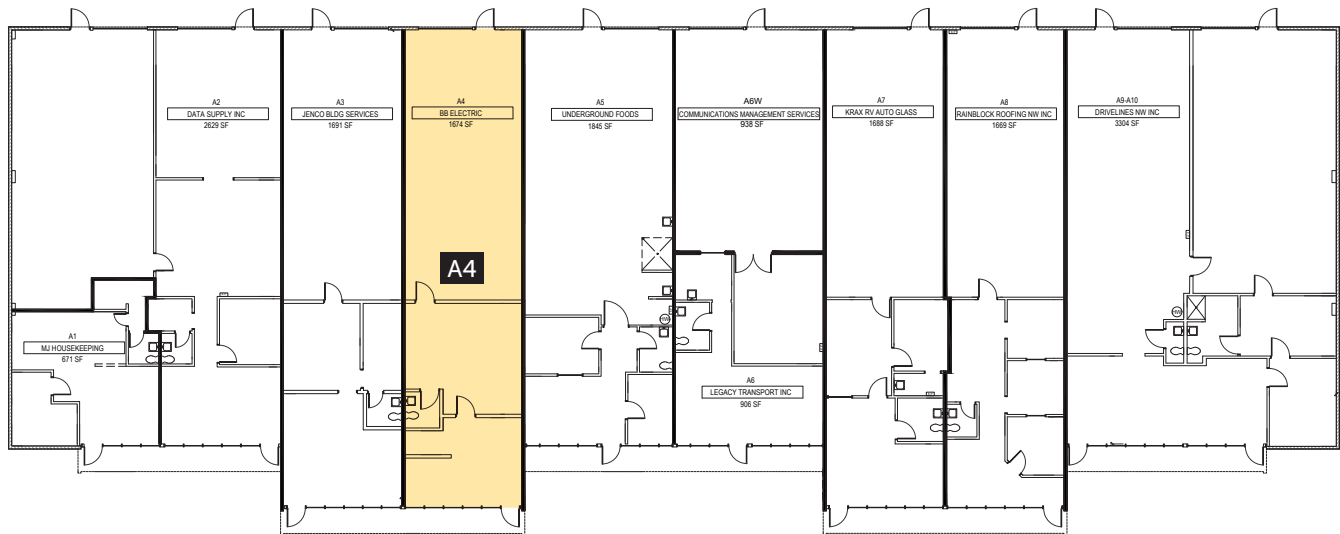

JOHN DEHAN
253.779.2433
jdehan@neilwalter.com

NICK RATZKE, SIOR
253.779.2414
nratzke@neilwalter.com

1940 East D St, #100
Tacoma, WA 98421
253.779.8400
www.neilwalter.com

All information references in this document are approximate. The information contained herein is contained from sources deemed reliable. It is provided without representation, warranty, or guarantee, expressed or implied as to accuracy. Prospective buyer or tenant should conduct its own independent investigation relating to the property, government codes and regulations, allowed uses, and all other matters, regardless of whether they are referred to or contained in this document.