

# FIFE BUSINESS CENTER

4624-4630 16TH ST E | FIFE, WA

NEW OWNERSHIP

MCA REALTY

FOR LEASE - 2 SUITES AVAILABLE

FLEX WAREHOUSE/OFFICE SPACE

Free Rent Available  
**FREE RENT AVAILABLE**  
Free Rent Available



## LEASE INFORMATION

Building	Suite	Available Size	Loading
B	9-10	4,543 SF	3 GL Doors
A	4	1,674 SF	1 GL Door

### Property Highlights

- New Cap-Ex Upgrades Completed
- Nearby amenities include food service, retail, banking, etc.
- Excellent I-5 and Port of Tacoma access
- Contact broker for lease rate

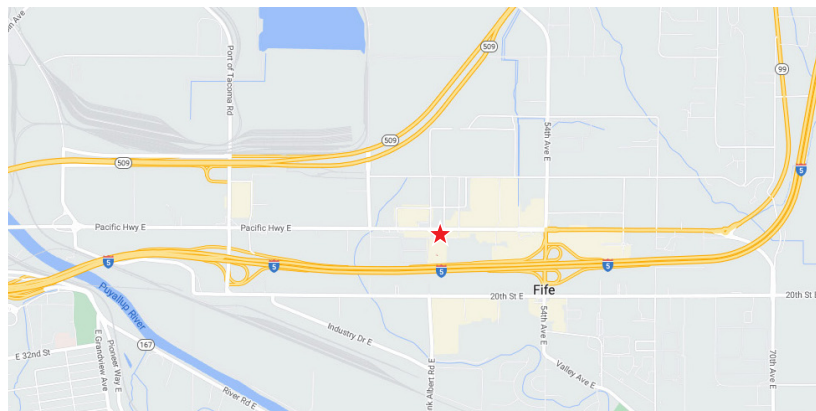

**JOHN DEHAN**  
253.779.2433

[jdehan@neilwalter.com](mailto:jdehan@neilwalter.com)

**NICK RATZKE, SIOR**  
253.779.2414

[nratzke@neilwalter.com](mailto:nratzke@neilwalter.com)

All information references in this document are approximate. The information contained herein is contained from sources deemed reliable. It is provided without representation, warranty, or guarantee, expressed or implied as to accuracy. Prospective buyer or tenant should conduct its own independent investigation relating to the property, government codes and regulations, allowed uses, and all other matters, regardless of whether they are referred to or contained in this document.

# FIFE BUSINESS CENTER

4624-4630 16TH ST E | FIFE, WA

## BUILDING B

SUITE	AVAILABLE SIZE	LOADING
B9-10	4,543 SF	3 GL Doors

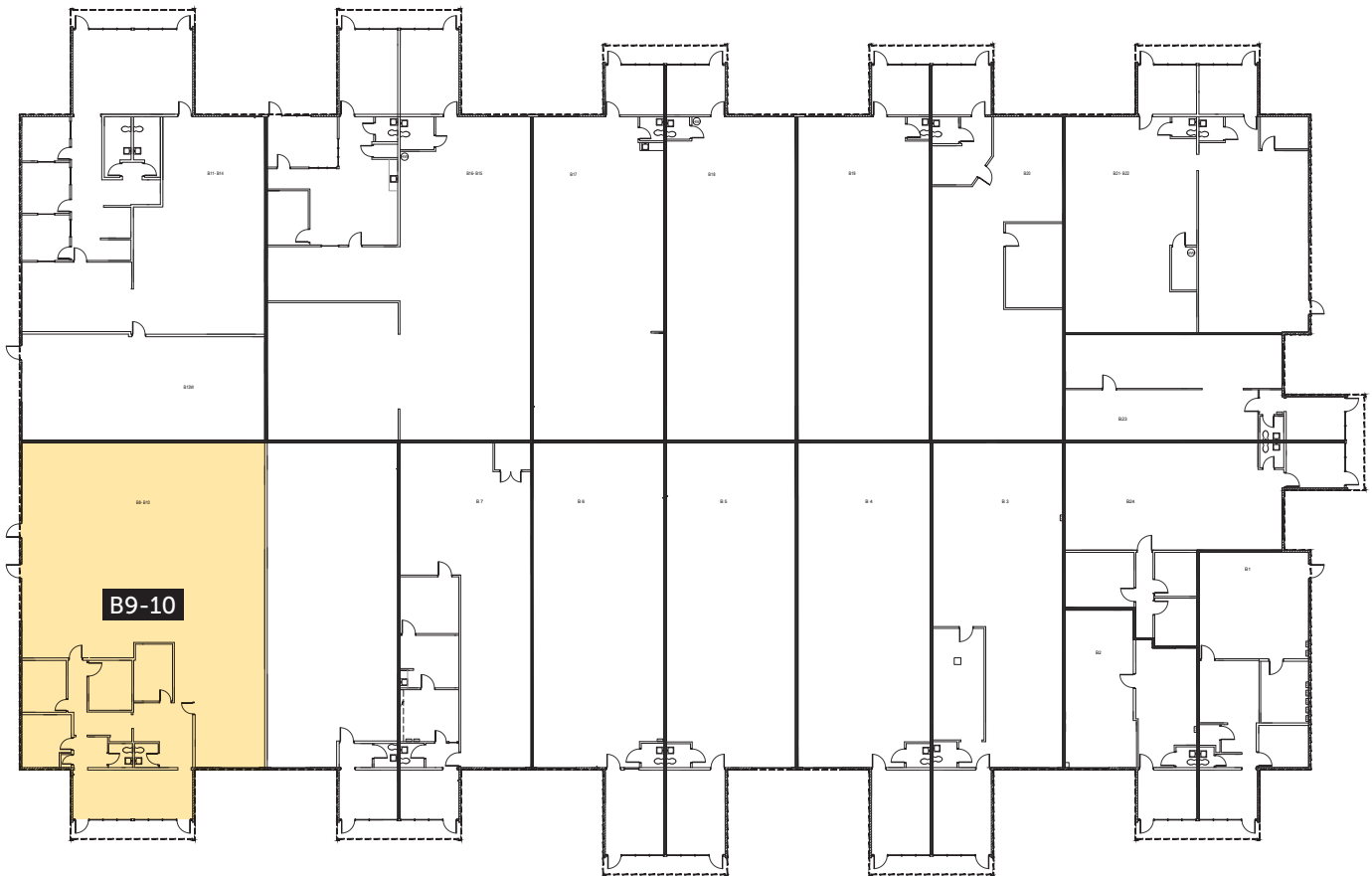

**JOHN DEHAN**  
253.779.2433  
jdehan@neilwalter.com

**NICK RATZKE, SIOR**  
253.779.2414  
nratzke@neilwalter.com

1940 East D St, #100  
Tacoma, WA 98421  
253.779.8400  
www.neilwalter.com

All information references in this document are approximate. The information contained herein is contained from sources deemed reliable. It is provided without representation, warranty, or guarantee, expressed or implied as to accuracy. Prospective buyer or tenant should conduct its own independent investigation relating to the property, government codes and regulations, allowed uses, and all other matters, regardless of whether they are referred to or contained in this document.

# FIFE BUSINESS CENTER

4624-4630 16TH ST E | FIFE, WA



NEIL WALTER  
COMPANY

## BUILDING A

SUITE	AVAILABLE SIZE	Loading
A4	1,674 SF	1 GL Door

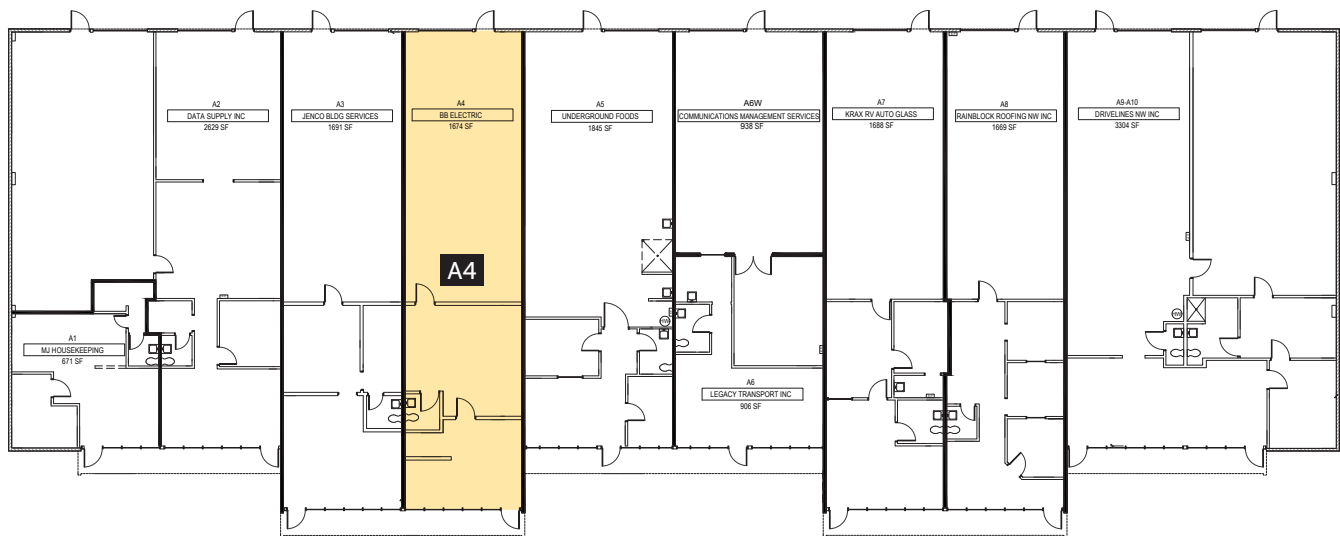

**JOHN DEHAN**  
253.779.2433

jdehan@neilwalter.com

**NICK RATZKE, SIOR**  
253.779.2414

nratzke@neilwalter.com

1940 East D St, #100  
Tacoma, WA 98421  
253.779.8400  
www.neilwalter.com

All information references in this document are approximate. The information contained herein is contained from sources deemed reliable. It is provided without representation, warranty, or guarantee, expressed or implied as to accuracy. Prospective buyer or tenant should conduct its own independent investigation relating to the property, government codes and regulations, allowed uses, and all other matters, regardless of whether they are referred to or contained in this document.