

# KENT CORPORATE PARK

FOR LEASE: 8,895 SF

22412-22426 72ND AVE S | KENT, WA

## KENT VALLEY WAREHOUSE SPACE AVAILABLE



### LEASE INFORMATION

**Building-Suite:** C-22412  
**Available Size:** 8,895 SF Total  
**Office Size:** 2,272 SF  
**Loading Doors:** 4 DH; 1 GL  
**Main Power:** 200A; 277/480V; 3P  
**Column Spacing:** 22'-6" x 48'-0"  
**Clear Height:** 18'  
**Available:** Now  
**Lease Rate:** \$1.05/SF Shell  
**(NNN)** \$1.35/SF Office  
(Discounted Office Available)  
**Note:** Great access to SR-167 and main thoroughfares in Kent



**JOEL JONES**  
253.219.9914  
jjones@neilwalter.com

**JACOB HANIGAN**  
253.389.0234  
jhanigan@neilwalter.com

**JOHN BLEDSOE**  
206.787.1460  
jbledsoe@neilwalter.com



All information references in this document are approximate. The information contained herein is contained from sources deemed reliable. It is provided without representation, warranty, or guarantee, expressed or implied as to accuracy. Prospective buyer or tenant should conduct its own independent investigation relating to the property, government codes and regulations, allowed uses, and all other matters, regardless of whether they are referred to or contained in this document.

# KENT CORPORATE PARK

22412-22426 72ND AVE S | KENT, WA

## BUILDING C-22412 8,895 SF Total | 2,272 SF Office

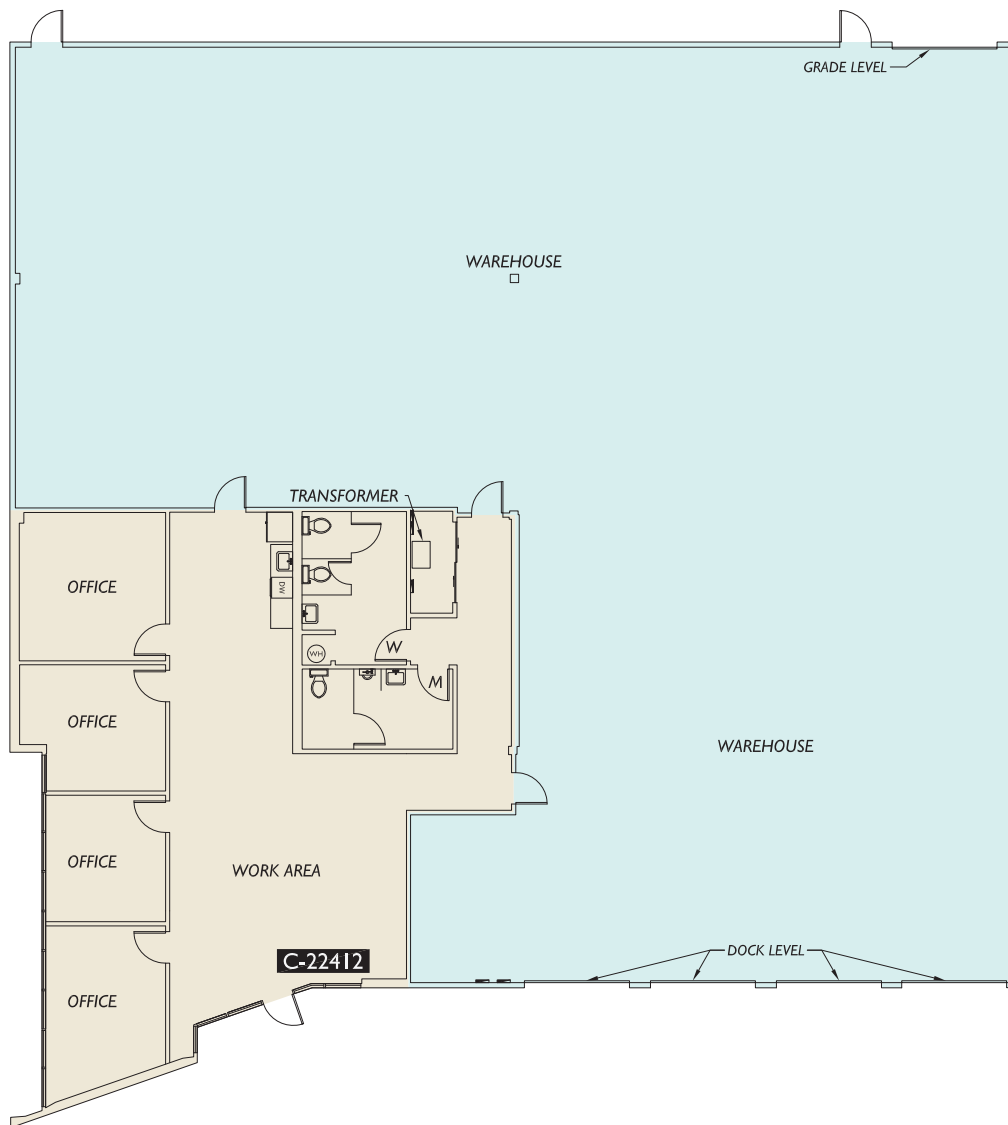

**JOEL JONES**  
253.219.9914  
jjones@neilwalter.com

**JACOB HANIGAN**  
253.389.0234  
jhanigan@neilwalter.com

**JOHN BLEDSOE**  
206.787.1460  
jbledsoe@neilwalter.com



All information references in this document are approximate. The information contained herein is contained from sources deemed reliable. It is provided without representation, warranty, or guarantee, expressed or implied as to accuracy. Prospective buyer or tenant should conduct its own independent investigation relating to the property, government codes and regulations, allowed uses, and all other matters, regardless of whether they are referred to or contained in this document.

# KENT CORPORATE PARK

22412-22426 72ND AVE S | KENT, WA

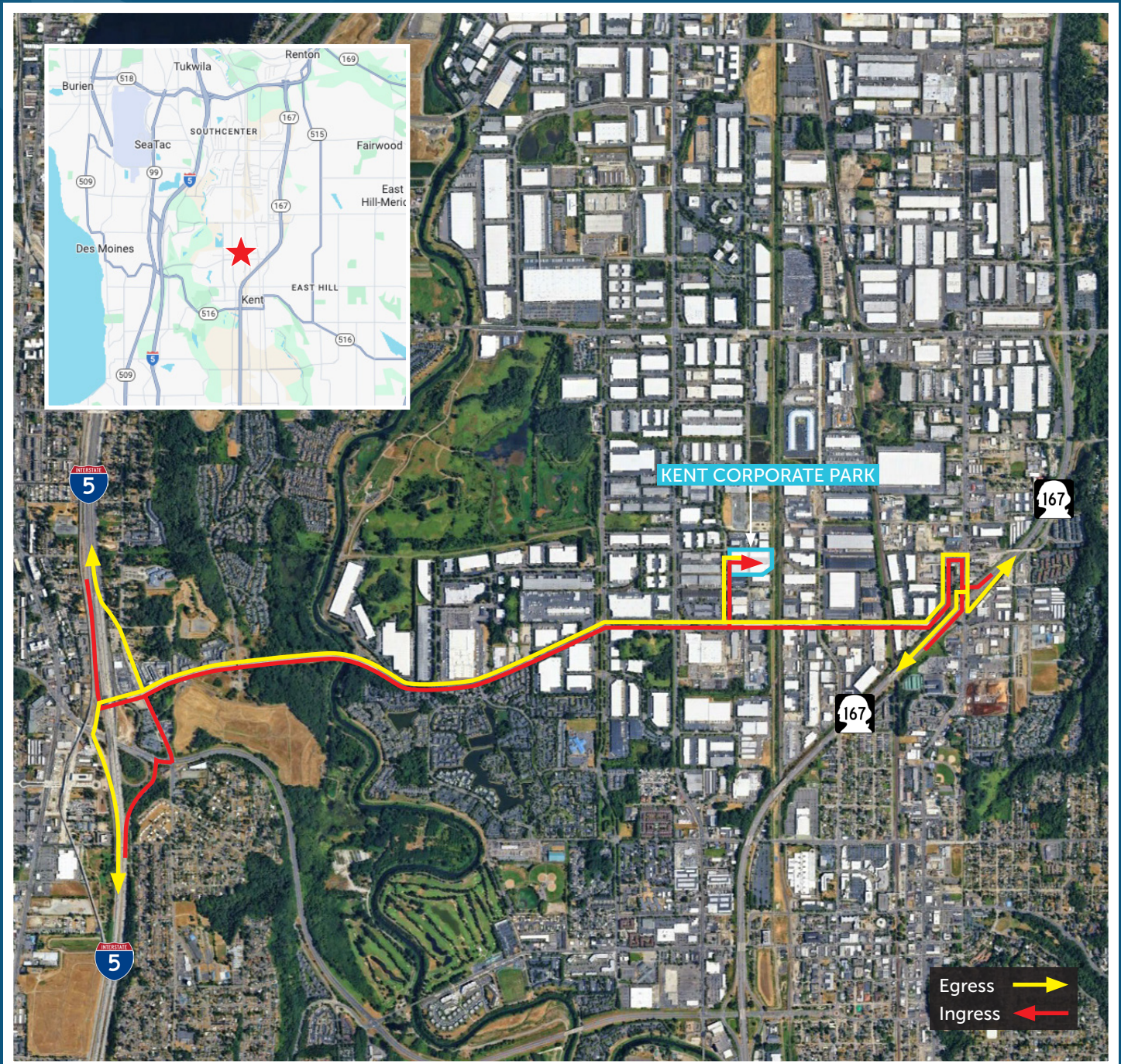

**JOEL JONES**  
253.219.9914  
jjones@neilwalter.com

**JACOB HANIGAN**  
253.389.0234  
jhanigan@neilwalter.com

**JOHN BLEDSOE**  
206.787.1460  
jbledsoe@neilwalter.com



All information references in this document are approximate. The information contained herein is contained from sources deemed reliable. It is provided without representation, warranty, or guarantee, expressed or implied as to accuracy. Prospective buyer or tenant should conduct its own independent investigation relating to the property, government codes and regulations, allowed uses, and all other matters, regardless of whether they are referred to or contained in this document.